

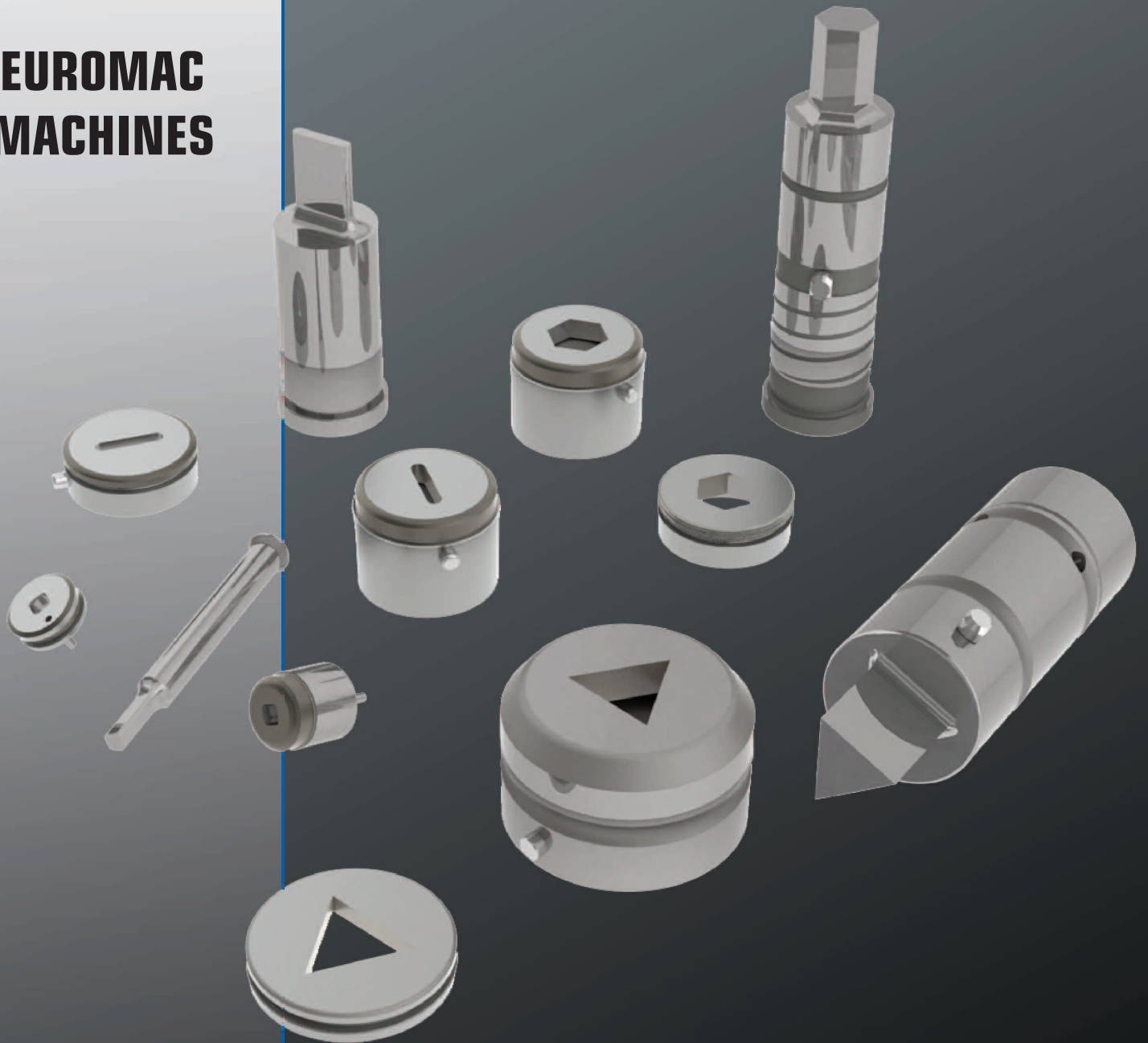

Wilson Tooling System

**EUROMAC
MACHINES**



TECHNOLOGY FOR INCREASED TOOL LIFE

OPTIMA COATING



The New Standard in Tooling Performance!

Optima™ is a proprietary TiCN (titanium carbo-nitride) coating that was custom engineered at our in-house coating facilities. It features unique properties that significantly enhance tooling performance. This coating, which is available only to Wilson Tool customers, provides a level of surface hardness, wear resistance and lubricity never before associated with coated or uncoated punch press tooling.

Some of the many benefits that you will enjoy with our Optima™ coating include:

- Longer tool life
- Increased wear resistance
- More hits between sharpenings
- Reduced adhesion (galling)
- Reduced slug pulling
- Reduced corner breakdown
- Improved special tooling performance
- Lower overall tooling costs
- In-house coating facilities allow us to deliver faster and maintain total quality control



PUNCH LIFE

Punch Life
Nibbling 14ga. (1.9mm) 304 Stainless Steel

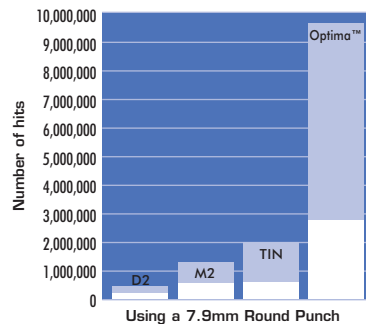

Using a 7.9mm Round Punch
The white area indicates actual results achieved through three tool sharpenings of 0.25mm each. The complete graph indicates projected results with a total of 6mm removed for sharpening.

NUMBER OF HITS

Number of Hits Before First Sharpening
Nibbling 14ga. (1.9mm) 304 Stainless Steel

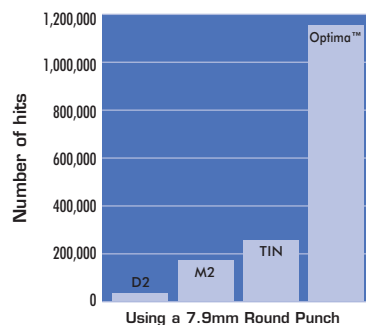

MATERIAL ADHESION

Square mm of Material Adhesion (Galling) on Punch Tips
Nibbling 12ga. (2.1mm) Aluminium

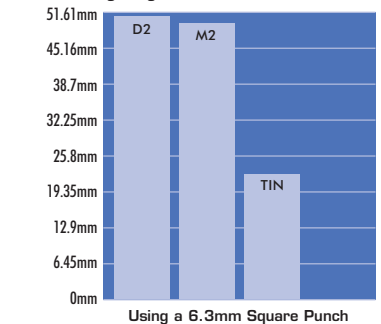

TIP WEAR

Punch Tip Corner Wear
Nibbling 14ga. (1.9mm) 304 Stainless Steel

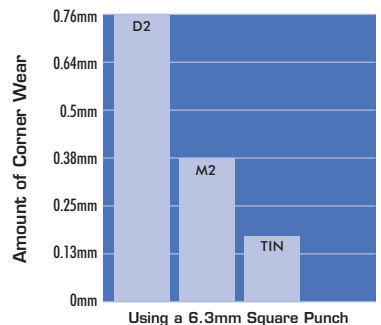

Optima
TECHNOLOGY AT THE CUTTING EDGE

Euromac MTE4 Punches, Strippers, Dies & Die Shims		
Description	Cat.No	Price
PUNCHES		
Round	2407	
Shape	2408	
STRIPPERS		
Round	1890	
Shape	1917	
DIES		
Positive Round	2021	
Round Slug Hugger®	2194	
Shape Positive	2025	
Shape Slug Hugger®	2195	
DIE SHIMS (Pkg of 25)		
0.25	2209	
0.75	2724	
1.5	2173	



Euromac XMTE6 (Long) Punches, Strippers, Dies & Die Shims		
Description	Cat.No	Price
PUNCHES		
Round	6916	
Shape	6917	
STRIPPERS		
Round	6918	
Shape	6920	
DIES		
Positive Round	6152	
Round Slug Hugger®	6189	
Shape Positive	6828/6155*	
Shape Slug Hugger®	6831/6195*	
DIE SHIMS (Pkg of 25)		
0.25	6823	
0.76	6824	
* A dimension over 19.05 refer to 6155 and 6195 shape dies.		



Euromac MTE10 Punches, Strippers, Dies & Die Shims				
Description	Cat.No	Price	Cat.No	Price
PUNCHES	24mm		8mm	
Round	6150		6080	
Shape	6153		6147	
STRIPPERS				
Round	6151		6146	
Shape	6827/6154		6148	
DIES				
Positive Round	6152		6081	
Round Slug Hugger®	6189		6185	
Shape Positive	6828/6155*		6149	
Shape Slug Hugger®	6831/6195*		6191	
DIE SHIMS (Pkg of 25)				
0.25	6823		Round 6817	
0.75	6824		Round 6818	
0.25	-		Shape 6819	
0.76	-		Shape 6820	
* A dimension over 19.05 refer to 6155 and 6195 shape dies.				



Euromac XMTE6 Punches, Strippers, Dies & Die Shims		
Description	Cat.No	Price
PUNCHES		
Round	6150	
Shape	6153	
STRIPPERS		
Round	6151	
Shape	6827/6154	
DIES		
Positive Round	6152	
Round Slug Hugger®	6189	
Shape Positive	6828/6155*	
Shape Slug Hugger®	6831/6195*	
DIE SHIMS (Pkg of 25)		
0.25	6823	
0.76	6824	
* A dimension over 19.05 refer to 6155 and 6195 shape dies.		



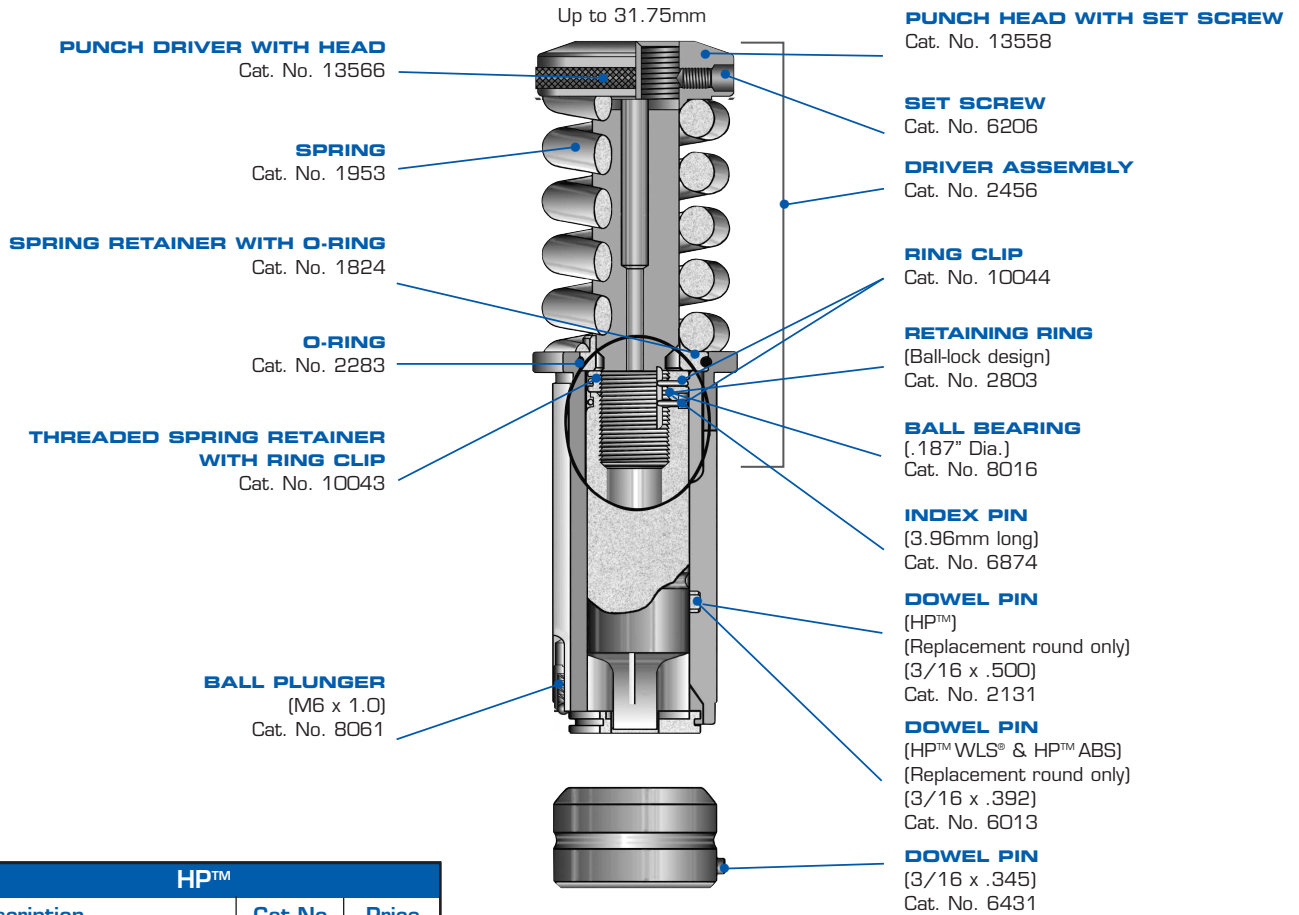

Maximum Material Thickness 6.35mm

HP™		
Description	Cat.No	Price
PUNCH & GUIDE ASSEMBLY		
Round	12827	
Shape Fitted	13167	
Optima® Add On	-	
Ultima™ Add On (Round)	-	
Ultima™ Add On (Shape)	-	
PUNCHES		
Round	2407	
Shape	2408	
Optima® Add On	-	
Ultima™ Add On (Round)	-	
Ultima™ Add On (Shape)	-	
GUIDES		
Round	2859	
Shape (0° & 45°)	2861	
Shape (0° & 90°)	2862	
STRIPPER PLATES		
Round	1890	
Shape	1917	
DIES		
Round Slug Hugger®	2194	
Round Standard	2021	
Shape Slug Hugger®	2195	
Shape Standard	2025	
Ultima™ Add On (Round)	-	
Ultima™ Add On (Shape)	-	
DIE SHIMS		
0.25	2209	
0.75	2724	
1.5	2173	

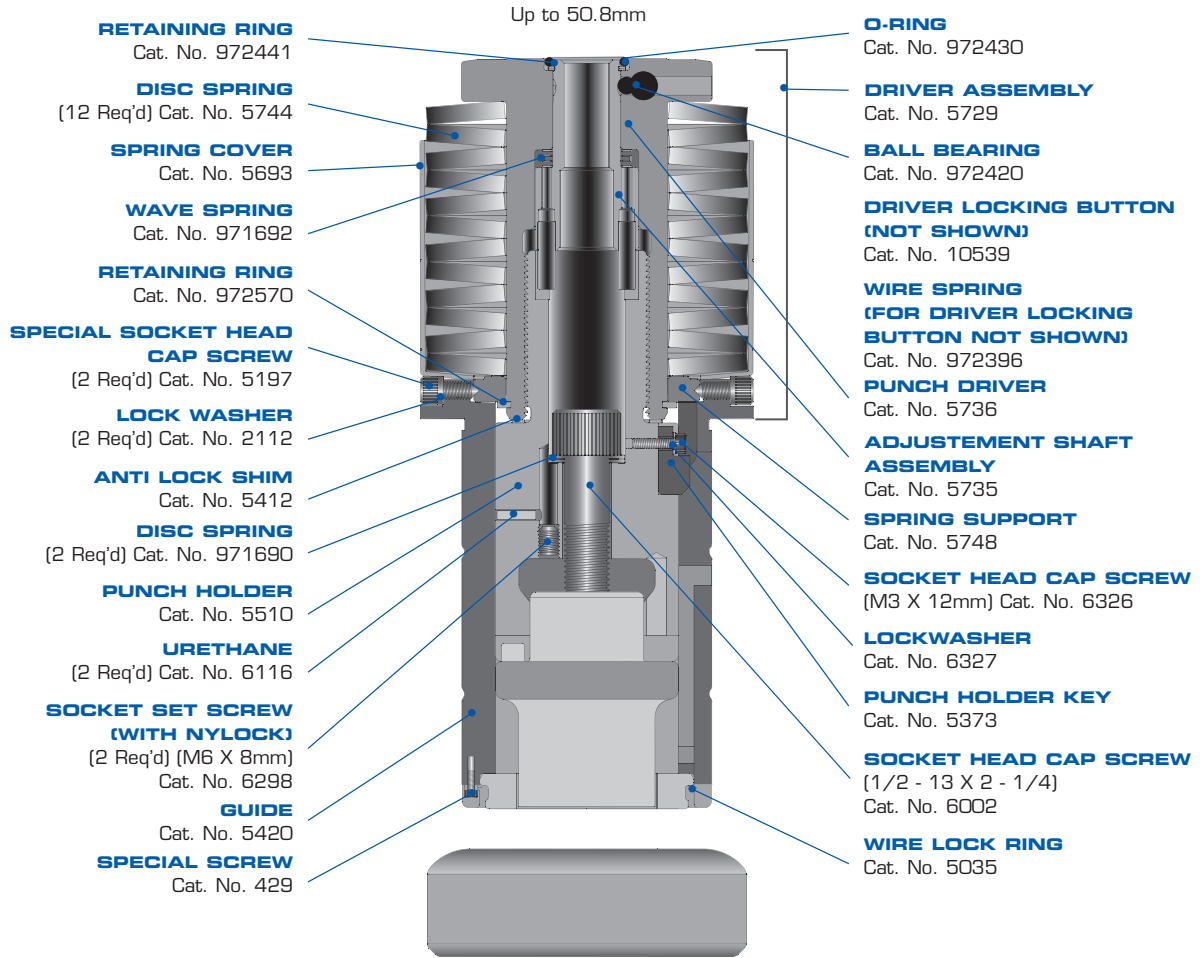

Maximum Material Thickness 6.35mm

HP™		
Description	Cat.No	Price
GUIDE ASSEMBLY	5586	
PUNCHES		
Round	5026	
Shape	5025	
Optima® Add On	-	
Ultima™ Add On (Round)	-	
Ultima™ Add On (Shape)	-	
STRIPPER PLATES		
Round	1848	
Shape	1854	
DIES		
Round Slug Hugger®	2196	
Round Standard	1850	
Shape Slug Hugger®	2197	
Shape Standard	1855	
Ultima™ Add On (Round)	-	
Ultima™ Add On (Shape)	-	
DIE SHIMS		
0.25	2210	
0.75	2726	
1.5	2174	

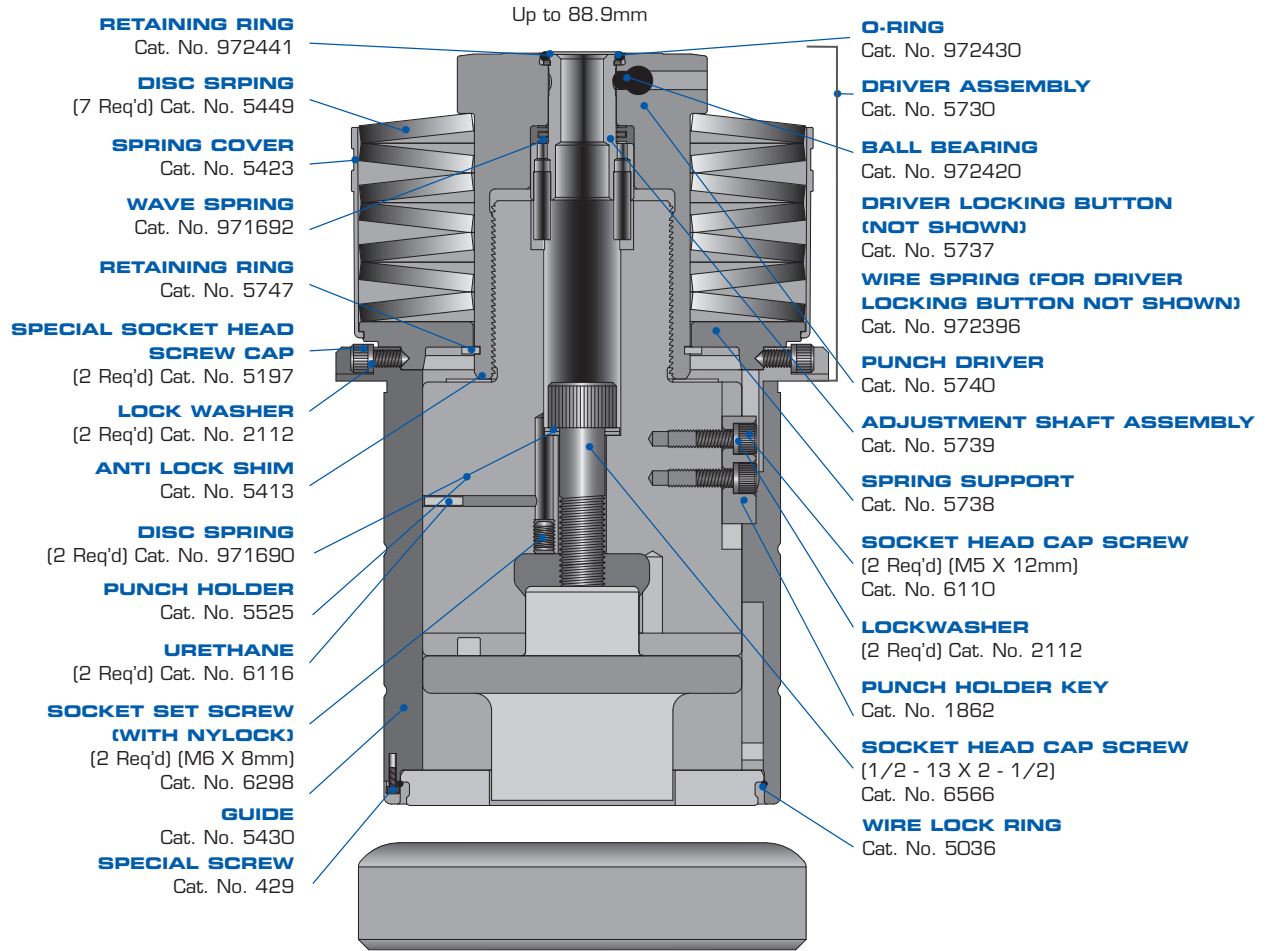

Maximum Material Thickness 6.35mm

HP™		
Description	Cat.No	Price
GUIDE ASSEMBLY	5587	
PUNCHES		
Round	5028	
Shape	5027	
Optima® Add On	-	
Ultima™ Add On (Round)	-	
Ultima™ Add On (Shape)	-	
STRIPPER PLATES		
Round	1864	
Shape	1869	
DIES		
Round Slug Hugger®	2198	
Round Standard	1865	
Shape Slug Hugger®	2199	
Shape Standard	1870	
Ultima™ Add On (Round)	-	
Ultima™ Add On (Shape)	-	
DIE SHIMS		
0.25	2211	
0.75	2728	
1.5	2175	

**1-1/4" (B) to 1/2" (A)
Station Adapter**

Description	Cat.No	Price
Punch & Guide Assembly Adapter (Keyed at 0° & 180°)	2284	
Die Adapter	2220	

**2" (C) to 1-1/4" (B)
Station Adapter**

Description	Cat.No	Price
Punch & Guide Assembly Adapter	2476	
Die Adapter	2475	



**3-1/2" (D) to 1-1/4" (B)
Station Adapter**

Description	Cat.No	Price
Punch & Guide Assembly Adapter (not shown)	2492	
Die Adapter	35058	

FEATURES & BENEFITS OF HP™ TOOLING

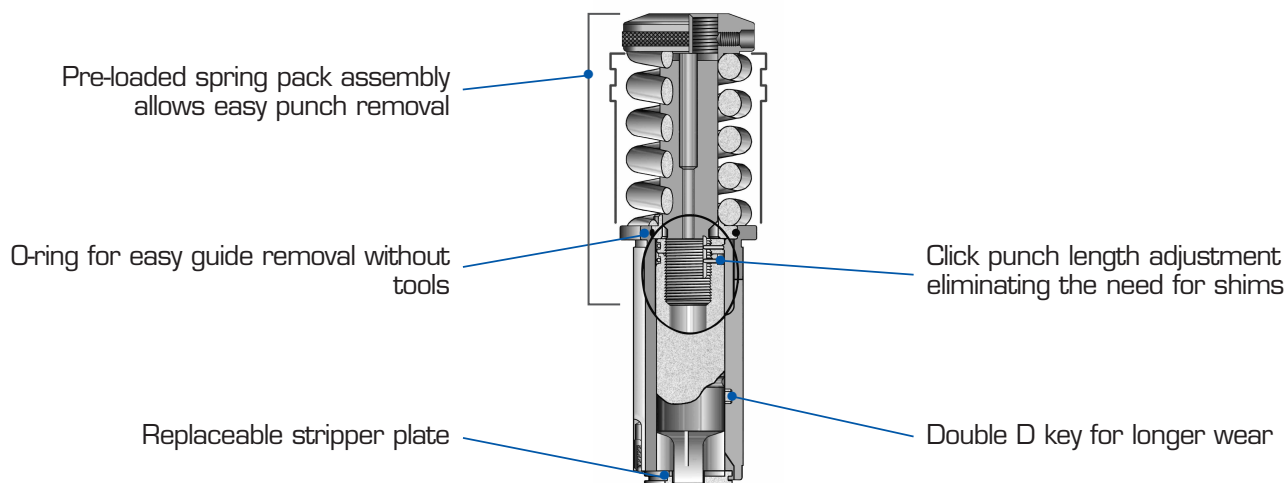

B Station



D Station

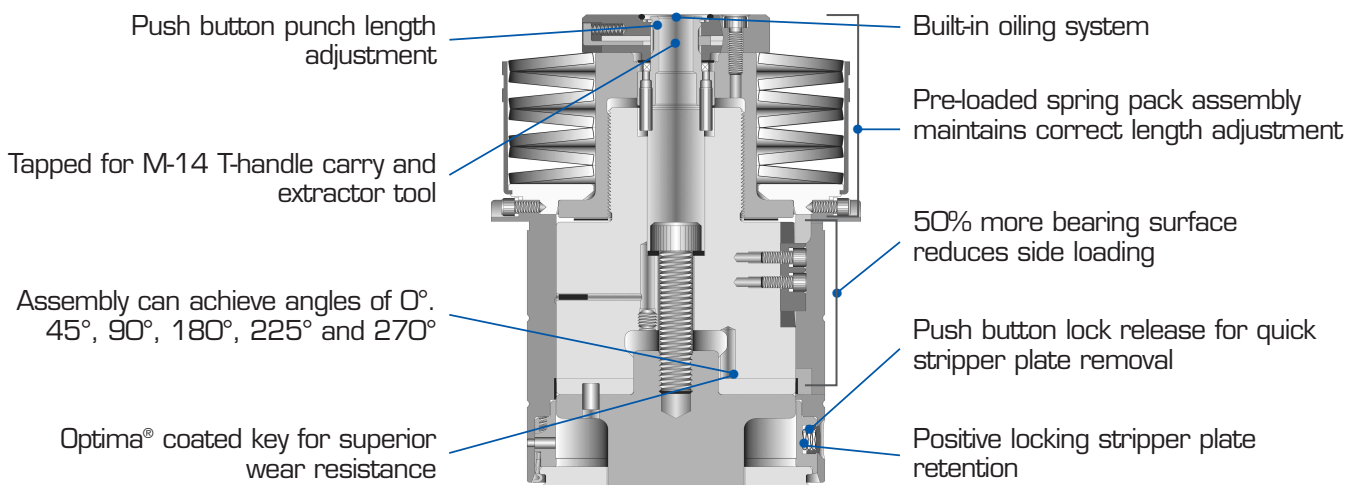

Standard Round Die

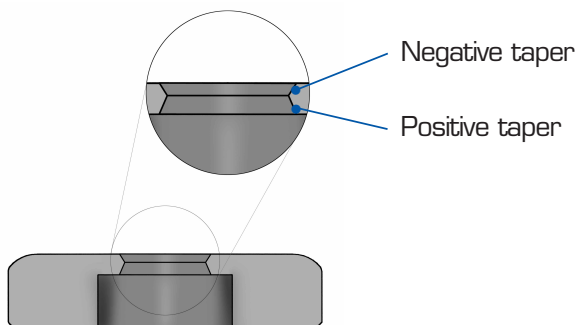

Slug Hugger® 2 Die



UK
Ireland

Tel (Free): 0800 373 748
Tel (Free): 1-800 709 009

Fax (Free): 0800 373 758
Fax (Free): 1-800 535 538

email: sales@wilsontool.eu.com



WILSON TOOL STANDARD SHAPES



OBROUND



DOUBLE 'D'

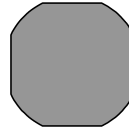

QUAD 'D'

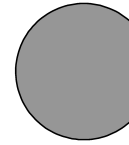

SINGLE 'D'

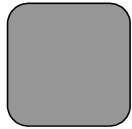
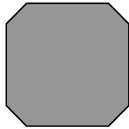
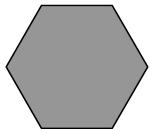
SQUARE
WITH RADSSQUARE
WITH CHAMFERSRECTANGLE
WITH RADSRECTANGLE
WITH CHAMFERS

HEXAGON

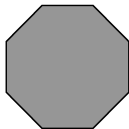

OCTAGON

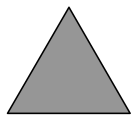
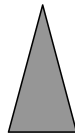

LONG 'D'

LONG 'D'
WITH RADSEQUILATERAL
TRIANGLEISOSCELES
TRIOANGLE

S4



S3 - S3A

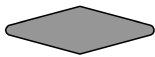

S9

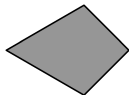

S1



S8



S7

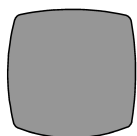

S165



S23

**ALL SHAPES SHOWN
ARE AVAILABLE AT
STANDARD PRICE.**

ORDER

Minimum order is £35.00.

DELIVERY CHARGE

Any larger items with a special delivery charge are indicated within the catalogue. Please call the sales desk for a delivery quotation on these issues.

CREDIT

All orders accepted are subject to the approval of our credit department. If you are a new account, please furnish us with a bank reference & three supplier references. A credit limit will be imposed on new accounts until credit has been established.

PAYMENT

Terms are net 30 days.

CANCELLATION

In the event an order is cancelled, charge will be made to cover labour, materials & overheads.

RETURNED MATERIAL

A handling charge of 25% is made on all standard parts returned for credit. Written permission & shipping instructions must be obtained before the return of any material. Special tooling cannot be returned.

CLAIMS

All claims for shortages must be made within 3 days of the invoice date.

PRICES

Prices & specifications subject to change without prior notice. E & OE. All prices are exclusive of VAT.

WILSON TOOL INTERNATIONAL (EUROPE) LTD

United Kingdom

European Headquarters

Stirling Road, South Marston
Industrial Estate, Swindon, Wiltshire
SN3 4TQ, United Kingdom
Tel (Free): 0800 373748
Tel: +44 (0)1793 831818
Fax (Free): 0800 373758
Fax: +44 (0)1793 831945
email: sales@wilsontool.eu.com

China

No. 6 Building of 58
4018 Lane Huaning Road
Xinhuang Industry Park
201108 Shanghai, China
Tel: +86 21 51089638
Fax: +86 21 64422195
email: sales@wilsontool.cn

France

Bat B,
51 Rue d'Ourdy, 77550 Réau, France
Tel: (Gratuit) 0800 10 29 00
Tel: +33 (0)1 64 13 47 80
Fax: (Gratuit) 0800 10 40 14
Fax: +33 (0)1 64 13 47 81
email: ventes@wilsontool.eu.com

Germany

Gottlieb Daimler Str 2
31552 Rodenberg, Germany
Tel: (Frei) 00800 945 766 8665
Tel: +49 (0)5723 747 0
Fax: (Frei) 00800 945 766 329
Fax: +49 (0)5723 747 10
email: verkauf@wilsontool.eu.com

Scandinavia

Islevdalvej 100
DK-2610, Rødovre, Denmark
Tel (Free): 80 20 20 24
Tel: +45 44 53 16 99
Fax (Free): 80 20 20 26
Fax: +45 44 53 06 07
email: salesdk@wilsontool.eu.com

email: sales@wilsontool.eu.com

Visit us online at: www.wilsontool.com

United States

Worldwide Headquarters

12912 Farnham Avenue
White Bear Lake, MN 55110 USA
Tel (Free): 800 328 9646
Tel: (651) 426 9133
Fax (Free): 800 222 0002
Fax: (651) 426 9134
email: marketing@wilsontool.com

Argentina

Wilson Tool International(r), Argentina
Von Wernicke 3041 PB
San Isidro, 1642 Buenos Aires
Argentina
Tel: +54 114 7634004
Fax: +54 114 5084190
email: ventasargentina@wilsontool.com

South Africa

Wilson Tool South Africa Limited
Rynhurst Business Park
156 Pretoria Road
Rynfield
Benoni
1501
Gauteng
Republic of South Africa
Tel: +27 877 217 875
Fax: 086 657 8629
email: simon.penney@wilsontool.com

Mexico

The Wilson Company SRL de CV
BLVD. Diaz Ordaz no 140 piso 20
Col. Santa Maria
Monterrey, Nuevo Leon
Mexico
C.P. 64650
Tel: 52 (81) 8865 4820
Fax: 52 (81) 8865 4599

